

GOL

NOTES:

1. THIS LAYOUT PLAN HAS BEEN PREPARED ON SURVEY OF LAND AND INFORMATION PROVIDED BY UNIT OFFICE.
2. UNIT OFFICE SHALL CHECK ALL THE INPUTS GIVEN IN THE SURVEY PLAN, IF THERE IS ANY VARIATION WITH RESPECT TO GROUND SITUATION, SAME MAY BE INFORMED TO HEAD OFFICE FOR NECESSARY AMENDMENTS.
3. ALLOTMENT OF PLOTS MAY BE DONE AFTER DEMARCATION OF LAND AT SITE. IF THERE IS ANY VARIATION, SAME MAY BE INFORMED TO HO FOR NECESSARY AMENDMENT.
4. ALL THE L. T. ELECTRIC LINES NOT IN THE ROAD ALIGNMENT SHALL BE SHIFTED, FOR H.T. ELECTRIC LINES (IF ANY), THE ELECTRICITY RULES SHALL BE FOLLOWED.
5. USE OF OPEN AREA (RAIN WATER HARVESTING AREA) AND SERVICES LAND MARKED IN THE LAYOUT SHALL BE UTILIZED AS PER TECHNICAL REQUIREMENT AND ITS SUITABILITY. ANY MODIFICATION REQUIRED ON ACCOUNT OF TECHNICAL REQUIREMENT SHALL BE DONE APPROPRIATELY.
6. UNIT OFFICE MAY TAKE APPROPRIATE ACTION FOR RESERVATION OF CONTIGUOUS 5 PLOTS OF 1000 SQM EACH FOR UNITS INVOLVED IN RECOVERY AND RECYCLING FACILITY AND CONTIGUOUS 2 PLOTS OF 500 SQM EACH FOR UNITS INVOLVED IN E-WASTE DISMANTLING AND RECYCLING FACILITIES AS PER RULES.
7. BUILDING PARAMETER FOR NON-INDUSTRIAL PLOTS SHALL BE APPLICABLE AS PER RIICO BUILDING REGULATIONS-2021.
8. UNIT OFFICE TO SUBMIT THE DEMARCATION PLAN FOR FINAL APPROVAL OF COMPETENT AUTHORITY.
9. THIS DRAWING HAS BEEN APPROVED BY COMMITTEE HEADED BY MD IN MEETING HELD ON DATED

SCHEDULE OF INDUSTRIAL PLOTS

TYPE	PLOT SIZE	AREA	NOS.	SETBACKS			
				FRONT	SIDE I	SIDE II	REAR
G	30.00 X 50.00	1500	20	5.00	3.00	-	2.50
G1	25.00 X 40.00	1000	50	3.00	3.00	-	1.20
H	20.00 X 35.00	700	61	3.00	3.00	-	1.20
H1	20.00 X 25.00	500	26	3.00	3.00	-	1.20
J	12.50 X 20.00	250	56	3.00	1.50	-	1.00
TOTAL NUMBER OF PLOTS				213			

SCHEDULE OF SHOPS

TYPE	PLOT SIZE	AREA (IN SQM.)	NOS.	SETBACKS	
				AS PER RIICO BUILDING REGULATIONS 2021	REFER DWG. NO. IPI/466/86
S1	3.00 X 7.50	22.50	25		
TOTAL NUMBER OF SHOPS				25	

LAND USE SCHEDULE

PARTICULARS	AREA (IN HECT.)	PERCENTAGE
TOTAL AREA UNDER SCHEME (AS PER REVENUE RECORDS)	25.000	-
TOTAL AREA UNDER SCHEME (AS PER PHYSICAL SURVEY)	25.000	-
AREA UNDER PLANNING	25.000	100.00%
AREA UNDER INDUSTRIAL PLOTS	15.576	62.30%
AREA UNDER COMMERCIAL	0.614	2.46%
AREA UNDER OPEN	1.296	5.18%
AREA UNDER SERVICES	1.301	5.20%
AREA UNDER ROAD	6.213	24.86%

TENTATIVE LAYOUT PLAN OF INDUSTRIAL AREA GOL, TEHSIL RIYABADI, NAGOUR

SCALE : 1 cm = 20.00 mtr.

DRG. NO.

(GAYTRI MEENA)
SR. DRAUGHTSMAN

(RAKESH VYAS)
PLANNING ASSISTANT

(VIKAS RAJ JAIN)
DY. TOWN PLANNER

(SANJAY M. WAGHMARE)
SR. TOWN PLANNER



RIICO

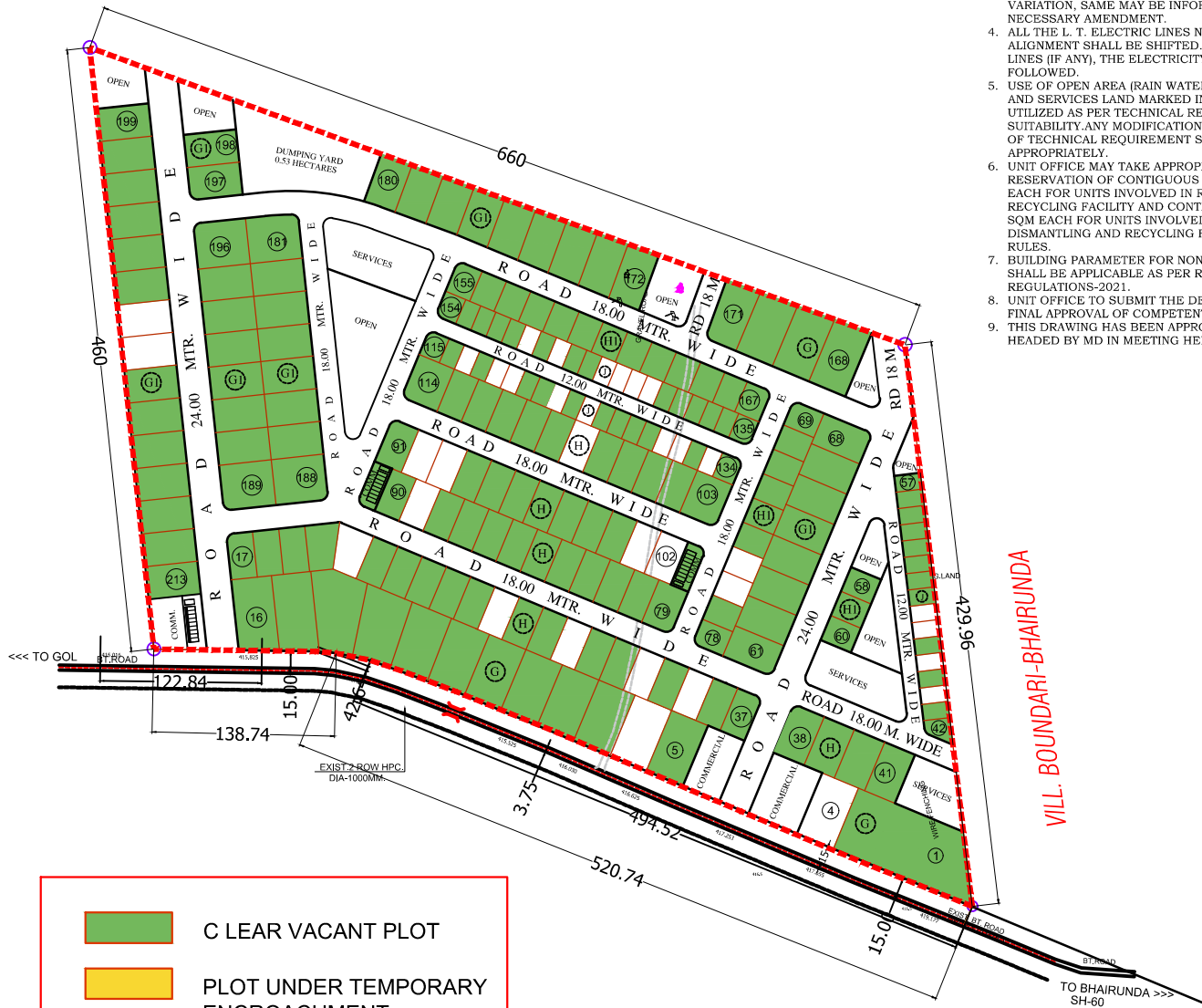

- C CLEAR VACANT PLOT
- PLOT UNDER TEMPORARY ENCROACHMENT
- PLOT UNDER ENCROACHMENT /DISPUTE / COURT CASE

VILL. BOUNDARI-BHAIRUNDA