

BIJAI-NAGAR

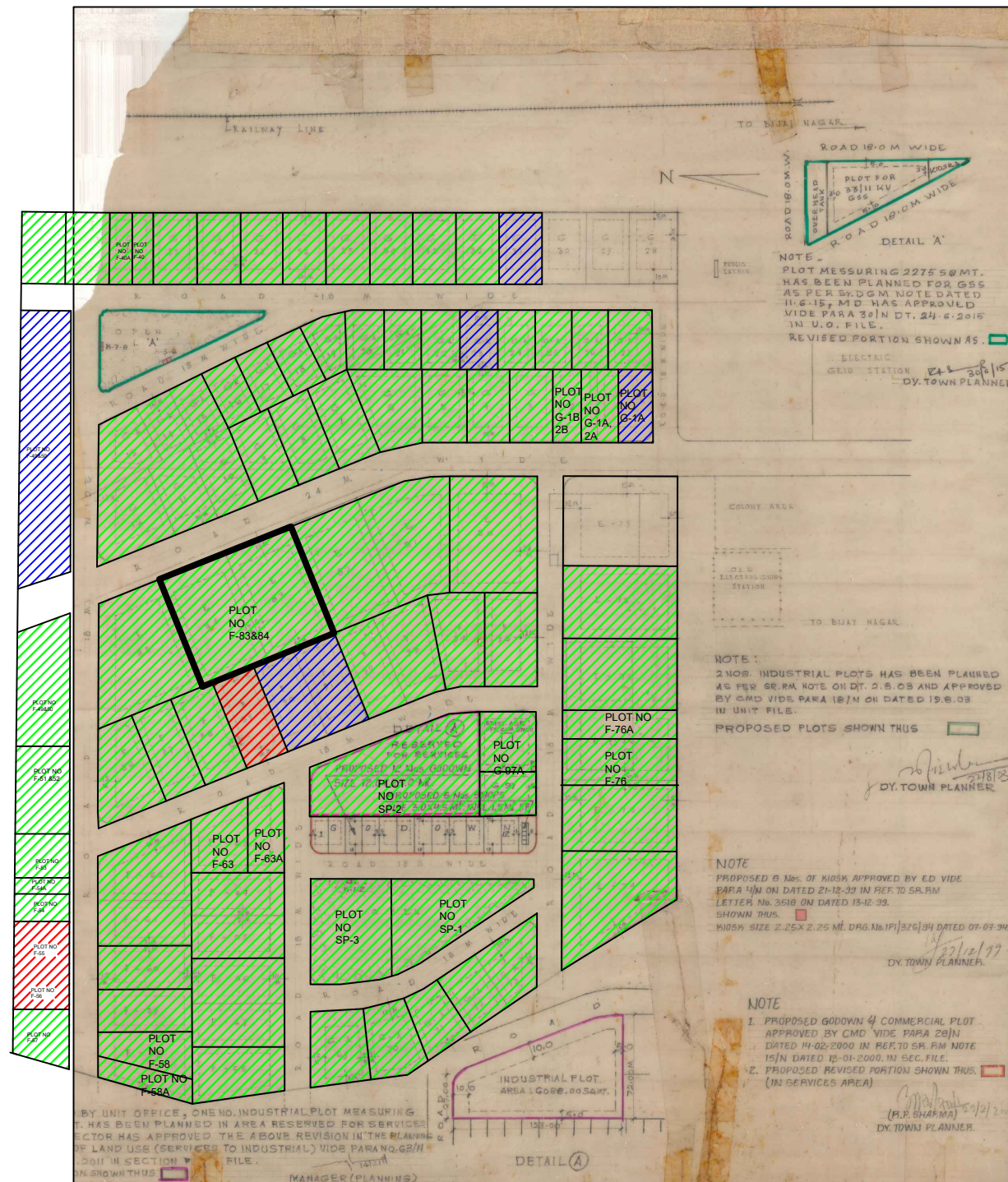

- NOTE:-**
- 1. VACANT
 - 2. CONSTRUCTED / UNDER CONSTRUCTION
 - 3. UTILIZED & FUNCTIONAL
 - 4. UTILIZED BUT NOT FUNCTIONAL NOW

TYPE	SIZE IN METERS	AREA IN SQ.M	No.	SET BACKS		
				FRONT	SIDE	R.F.C.
E	30 M X 30 M	4,000 M ²	12	12 M	5 M	
F	30 M X 25 M	2,000 M ²	35	10 M	5 M	
G	20 M X 30 M	15,000 M ²	28	10 M	5 M	
G-1	25 M X 40 M	10,000 M ²	20	10 M	3 M	
TOTAL			95			

LAND USE

AREA UNDER SCHEME	IN ACRES	%
" " PLOTS	46.70	70.30%
" " ROADS	15.27	21.03%
" " OPEN	2.61	3.93%
" " SERVICES	3.15	4.74%
TOTAL	66.43	100.00%

LAY OUT PLAN OF INDUSTRIAL AREA, BIJAINAGAR, RAJASTHAN.

DEPT. BY: *[Signature]*
 (B. S. RAJNAR) SENIOR DRAWINGS MAN
 SCALE: 1 CM = 15 M
 DATE: 30.02.2015
 DRAWING NO: IP/1707/2011 DT. 14.02.11
 AMPT/CL/177
 IP/1820/33 DT. 24.12.10
 IP/11216/2015 DT. 30.02.2015
 IP/1854/2000 DT. 20.06.2000
 IP/34/2008 DT. 02.05.08

BY UNIT OFFICE, ONE NO. INDUSTRIAL PLOT MEASURING 2275.50 MT. HAS BEEN PLANNED IN AREA RESERVED FOR SERVICES SECTOR HAS APPROVED THE ABOVE REVISION IN THE PLAN OF LAND USE (SERVICES TO INDUSTRIAL) VIDE PARA NO. 62/N/2011 IN SECTION 13(1) FILE.
 MANAGER (PLANNING)

INDUSTRIAL PLOT AREA: 1.0088.00 SQ.M.
 DETAIL A

NOTE:
 1. PROPOSED GODDOWN 4 COMMERCIAL PLOT APPROVED BY CMD VIDE PARA 28/N DATED 14-02-2000 IN REF. TO SR.FRM LETTER NO. 3618 ON DATED 13-12-99.
 2. PROPOSED REVISED PORTION SHOWN THUS (IN SERVICES AREA)

NOTE:
 2 NOS. INDUSTRIAL PLOTS HAS BEEN PLANNED AS PER SR.FRM NOTE ON DT. 2.8.03 AND APPROVED BY CMD VIDE PARA 18/N ON DATED 19.8.03 IN UNIT FILE.
 PROPOSED PLOTS SHOWN THUS

NOTE:
 2 NOS. INDUSTRIAL PLOTS HAS BEEN PLANNED AS PER SR.FRM NOTE ON DT. 2.8.03 AND APPROVED BY CMD VIDE PARA 18/N ON DATED 19.8.03 IN UNIT FILE.
 PROPOSED PLOTS SHOWN THUS

NOTE:
 1. PROPOSED GODDOWN 4 COMMERCIAL PLOT APPROVED BY CMD VIDE PARA 28/N DATED 14-02-2000 IN REF. TO SR.FRM LETTER NO. 3618 ON DATED 13-12-99.
 2. PROPOSED REVISED PORTION SHOWN THUS (IN SERVICES AREA)

BY: *[Signature]*
 (M.P. SHARMA) DY. TOWN PLANNER

BY UNIT OFFICE, ONE NO. INDUSTRIAL PLOT MEASURING 2275.50 MT. HAS BEEN PLANNED IN AREA RESERVED FOR SERVICES SECTOR HAS APPROVED THE ABOVE REVISION IN THE PLAN OF LAND USE (SERVICES TO INDUSTRIAL) VIDE PARA NO. 62/N/2011 IN SECTION 13(1) FILE.
 MANAGER (PLANNING)

INDUSTRIAL PLOT AREA: 1.0088.00 SQ.M.
 DETAIL A

NOTE:
 2 NOS. INDUSTRIAL PLOTS HAS BEEN PLANNED AS PER SR.FRM NOTE ON DT. 2.8.03 AND APPROVED BY CMD VIDE PARA 18/N ON DATED 19.8.03 IN UNIT FILE.
 PROPOSED PLOTS SHOWN THUS

NOTE:
 2 NOS. INDUSTRIAL PLOTS HAS BEEN PLANNED AS PER SR.FRM NOTE ON DT. 2.8.03 AND APPROVED BY CMD VIDE PARA 18/N ON DATED 19.8.03 IN UNIT FILE.
 PROPOSED PLOTS SHOWN THUS

NOTE:
 1. PROPOSED GODDOWN 4 COMMERCIAL PLOT APPROVED BY CMD VIDE PARA 28/N DATED 14-02-2000 IN REF. TO SR.FRM LETTER NO. 3618 ON DATED 13-12-99.
 2. PROPOSED REVISED PORTION SHOWN THUS (IN SERVICES AREA)

BY: *[Signature]*
 (M.P. SHARMA) DY. TOWN PLANNER

BY UNIT OFFICE, ONE NO. INDUSTRIAL PLOT MEASURING 2275.50 MT. HAS BEEN PLANNED IN AREA RESERVED FOR SERVICES SECTOR HAS APPROVED THE ABOVE REVISION IN THE PLAN OF LAND USE (SERVICES TO INDUSTRIAL) VIDE PARA NO. 62/N/2011 IN SECTION 13(1) FILE.
 MANAGER (PLANNING)

INDUSTRIAL PLOT AREA: 1.0088.00 SQ.M.
 DETAIL A

NOTE:
 2 NOS. INDUSTRIAL PLOTS HAS BEEN PLANNED AS PER SR.FRM NOTE ON DT. 2.8.03 AND APPROVED BY CMD VIDE PARA 18/N ON DATED 19.8.03 IN UNIT FILE.
 PROPOSED PLOTS SHOWN THUS

NOTE:
 2 NOS. INDUSTRIAL PLOTS HAS BEEN PLANNED AS PER SR.FRM NOTE ON DT. 2.8.03 AND APPROVED BY CMD VIDE PARA 18/N ON DATED 19.8.03 IN UNIT FILE.
 PROPOSED PLOTS SHOWN THUS

NOTE:
 1. PROPOSED GODDOWN 4 COMMERCIAL PLOT APPROVED BY CMD VIDE PARA 28/N DATED 14-02-2000 IN REF. TO SR.FRM LETTER NO. 3618 ON DATED 13-12-99.
 2. PROPOSED REVISED PORTION SHOWN THUS (IN SERVICES AREA)

BY: *[Signature]*
 (M.P. SHARMA) DY. TOWN PLANNER

BY UNIT OFFICE, ONE NO. INDUSTRIAL PLOT MEASURING 2275.50 MT. HAS BEEN PLANNED IN AREA RESERVED FOR SERVICES SECTOR HAS APPROVED THE ABOVE REVISION IN THE PLAN OF LAND USE (SERVICES TO INDUSTRIAL) VIDE PARA NO. 62/N/2011 IN SECTION 13(1) FILE.
 MANAGER (PLANNING)

INDUSTRIAL PLOT AREA: 1.0088.00 SQ.M.
 DETAIL A

NOTE:
 2 NOS. INDUSTRIAL PLOTS HAS BEEN PLANNED AS PER SR.FRM NOTE ON DT. 2.8.03 AND APPROVED BY CMD VIDE PARA 18/N ON DATED 19.8.03 IN UNIT FILE.
 PROPOSED PLOTS SHOWN THUS

NOTE:
 2 NOS. INDUSTRIAL PLOTS HAS BEEN PLANNED AS PER SR.FRM NOTE ON DT. 2.8.03 AND APPROVED BY CMD VIDE PARA 18/N ON DATED 19.8.03 IN UNIT FILE.
 PROPOSED PLOTS SHOWN THUS

NOTE:
 1. PROPOSED GODDOWN 4 COMMERCIAL PLOT APPROVED BY CMD VIDE PARA 28/N DATED 14-02-2000 IN REF. TO SR.FRM LETTER NO. 3618 ON DATED 13-12-99.
 2. PROPOSED REVISED PORTION SHOWN THUS (IN SERVICES AREA)

BY: *[Signature]*
 (M.P. SHARMA) DY. TOWN PLANNER