

SANGRIYA

SCHEDULE OF PLOTS

TYPE	SIZE IN MTS	AREA	NOS.	SET BACKS		
				FRONT	SIDE	REAR
H	20.00 x 35.00	700.00	46	4.00	3.00	2.00
H ₁	20.00 x 25.00	500.00	27	3.00	3.00	2.00
H ₂	12.00 x 25.00	300.00	96	3.00	1.50	1.50
J ₁	10.00 x 20.00	200.00	53	3.00	1.50	1.50
S	5.00 x 10.00 (INCL. 1.5MT.F.F.)	50.000	8	IPI/74/82		24-04-82
S ₁	3.00 x 7.50 (INCL. 1.5MT.F.F.)	22.00	12	IPI/466/86		24-04-86
TOTAL NO OF PLOTS & SHOPS			222/20			

LAND USE

S.NO.	PARTICULARS	AREA (IN ACRES.)	%AGE
1.	TOTAL SCHEME AREA (AS PER REVENUE / SURVEY)	61.8	
2.	AREA UNDER IND. PLOTS	22.20	36
3.	AREA UNDER ROAD	21.0	34
4.	AREA UNDER SERVICES	0.41	.65
5.	AREA UNDER COMMERCIAL	0.36	.60
6.	AREA UNDER C.E.T.P.	9.00	3.0
7.	AREA UNDER NADI, WOODLAND	5.65	14.7
8.	AREA UNDER GSS	0.75	9.1
9.	AREA UNDER OPEN	1.83	1.2
10.	AREA UNDER NALAH	0.60	0.75

TENTATIVE LAY OUT PLAN FOR MINI GROWTH CENTRE PHASE II SANGRIYA JODHPUR (RAJ.)

SCALE 1 CM = 10 MT.	DRG.No	IPI/466/96	DT.21-9-19996
M.L. SHARMA Sr.Draughtsman	REV.I	IPI/1135/2002	DT.21-2-2002
	REV.II	IPI/287/2006	DT.21-7-2006
	REV.III	IPI/441/2008	DT.24-3-2008
	REV.IV	IPI/528/2009	DT.26-01-2009
	REV.V	IPI/780/2011	DT.08-10-2011

D.K. JHA
A.R.M.

VINEET GUPTA
Sr.RegionalManager

RIICO

NOTE:

PLOT UNDER ENCROACHMENT / DISPUTE

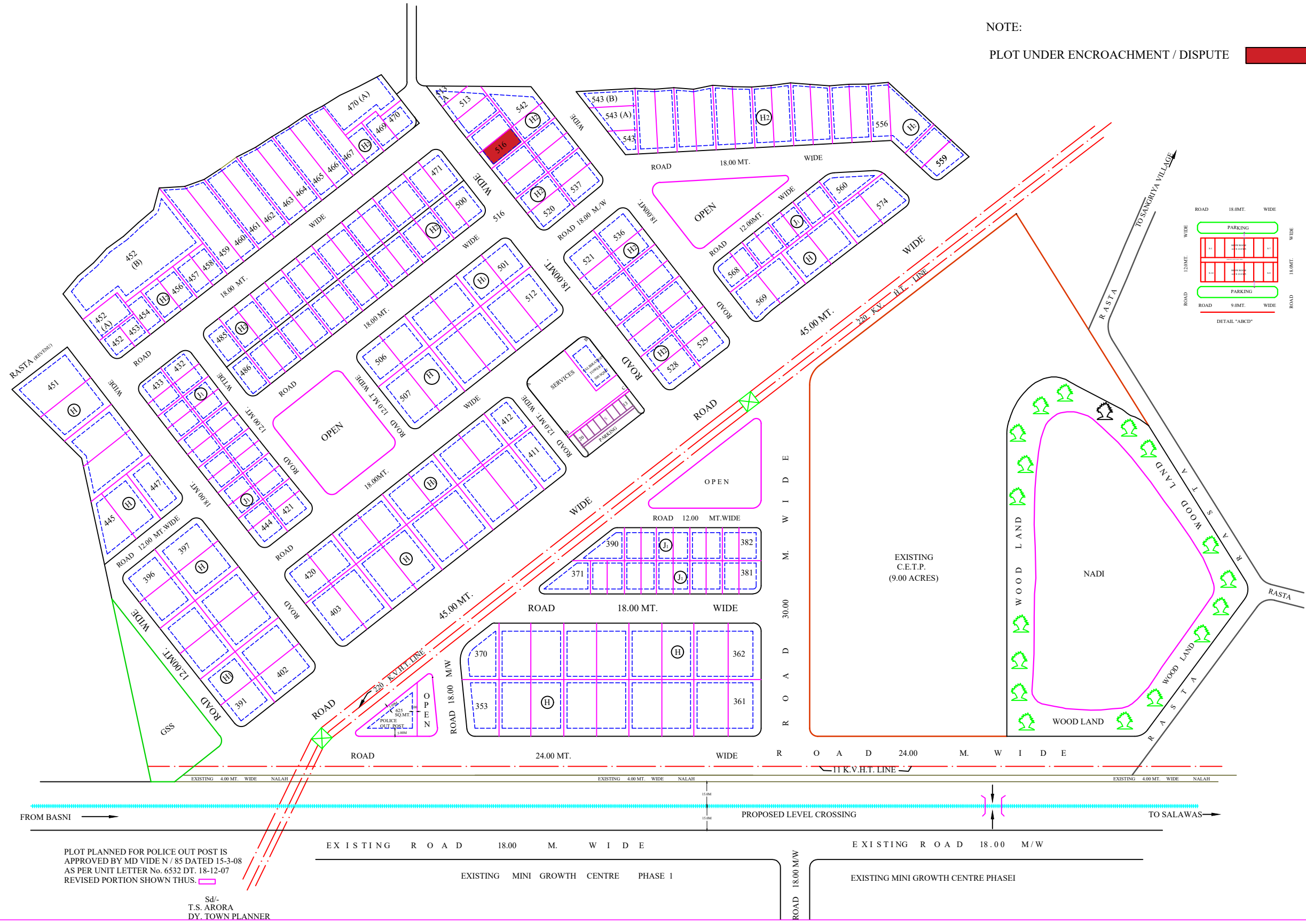

PLOT PLANNED FOR POLICE OUT POST IS APPROVED BY MD VIDE N / 85 DATED 15-3-08 AS PER UNIT LETTER No. 6532 DT. 18-12-07 REVISED PORTION SHOWN THUS.

Sd/-
T.S. ARORA
DY. TOWN PLANNER

