

CLEAR VACANT PLOTS SHOW IN THIS  
IND. PLOTS 82 NOS.

DISPUTED PLOTS SHOW IN  
THIS  
IND. PLOTS 0 NOS.

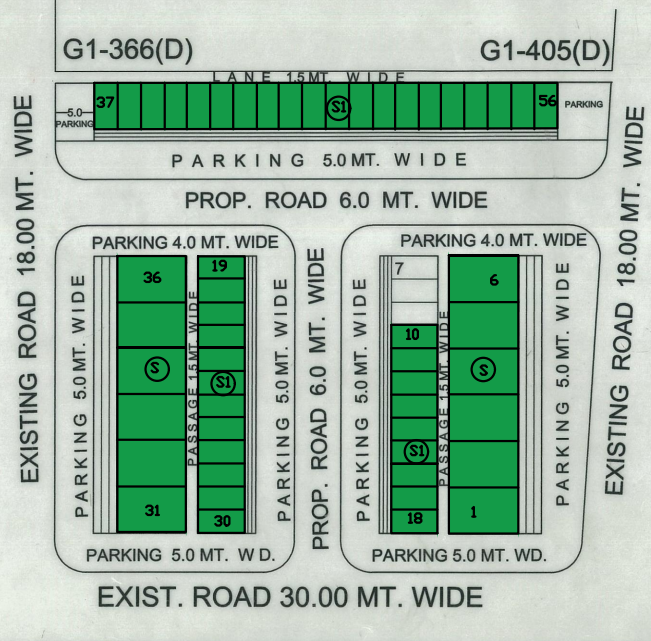

SCHEDULE OF SHOPS					
TYPE	SIZE (IN MTS)	AREA (IN SQM)	NOS.	REMARK	
S	6.0X12.0	72.00	12	DRG NO. IPI/84/90 DT. 01.09.90	
S1	3.0X7.5	22.50	44	DRG NO. IPI/466/86 DT. 28.04.86	
TOTAL			56		

**PROPOSED COMMERCIAL SHOPS AT INDUSTRIAL AREA KISHANGARH PH.-IV (IN INDUSTRIAL PLOT E-406a & E-406b)**

SCALE :- 1 CM=5.0 MT. DRG. NO. IPI/239/2006 DT. 25.01.2006

*Rakesh Vyas*  
RAKESH VYAS  
SR. DRAUGHTSMAN

*Sanjay M. Waghmare*  
SANJAY M. WAGHMARE  
MANAGER PLANNING

*T. S. Arora*  
T. S. ARORA  
DY. TOWN PLANNER

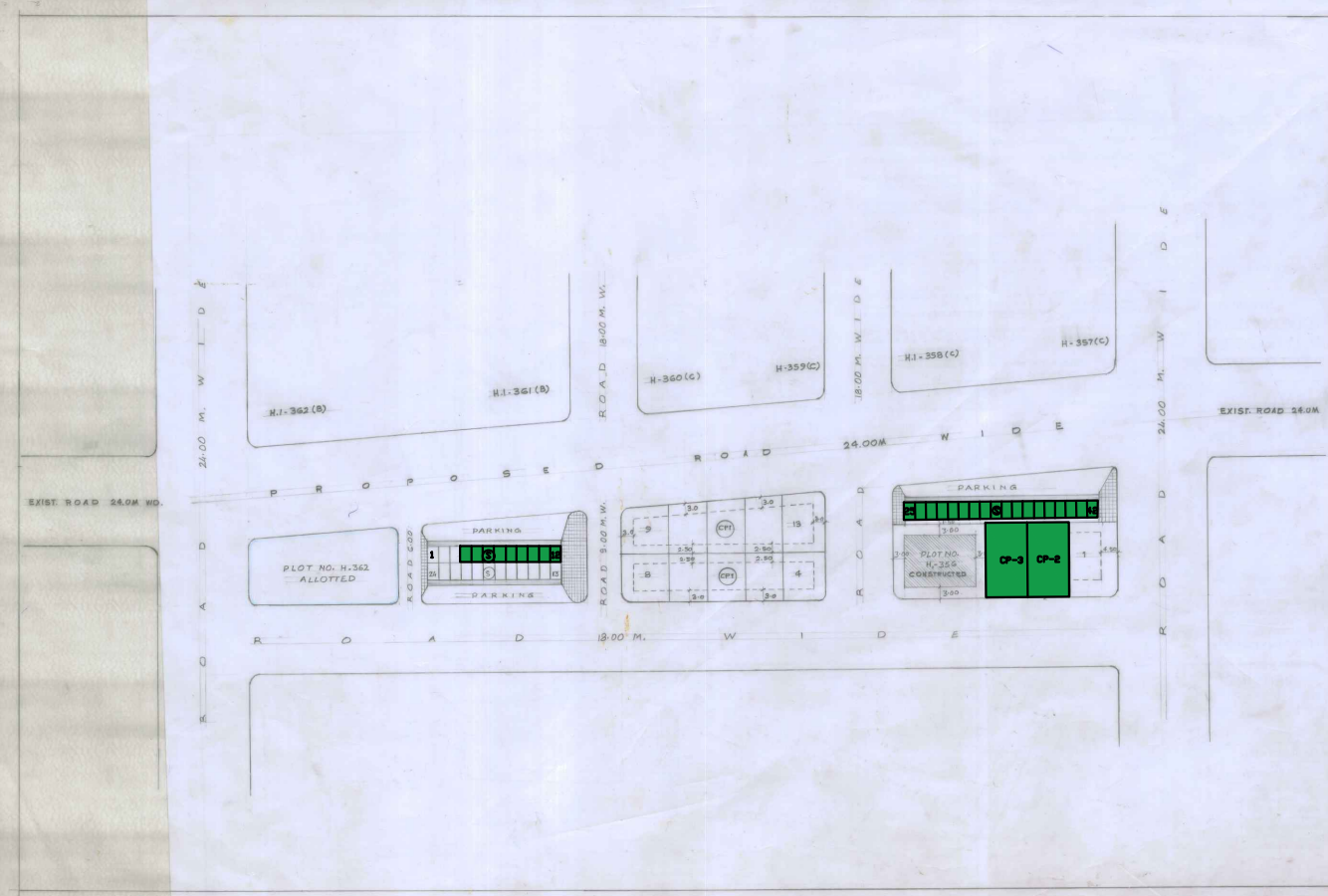

**SCHEDULE OF PLOTS:**

SNO.	SIZE IN MTR.	AREA	NOS.	SET BACKS		
				FRONT	SIDES	REAR
CR	11.40X28.00	319.20	5	4.80	-	2.80
CP1	4.5 PER SITE	18.00M	10	3.00	-	2.50
S	3.00X7.50	22.50	44	3.00	-	2.50
TOTAL NOS. OF PLOTS				15	44	

**REFERENCES:**  
ALLOTTED PLOT SHOWN THIS  
CONSTRUCTED PLOT SHOWN THIS  
PROPOSED ROAD SHOWN THIS

**NOTE:**  
\* THIS DRAWING HAS BEEN PREPARED AS PER SR. RA  
LETTER NO. 2834 DT. 10.01.03, 2965 DT. 09.01.03 AND  
APPROVED BY MANAGING DIRECTOR, I.A. PHA NO.  
38/N ON DATED 06.02.2006 IN UNIT FILE.  
\* THIS PLAN IS RELEASED FOR DEMARCATION PURPOSE.  
THE FINAL PLAN SHALL BE RELEASED AFTER  
DEMARCATION PLAN IS RECEIVED AND APPROVED  
BY COMPETENT AUTHORITY.

**NOTE:**  
IN VIEW OF UNIT LETTER NO. 3884 DATED 18.01.03  
THAT THERE ARE NO DIVISIONS IN DEMARCATION.  
THIS PLAN MAY BE DEEMED AS APPROVED IN  
LIGHT OF ORDER NO. IPI/239/2006 DT. 25.01.06

PRAVESH JAIN  
DY. TOWN PLANNER

**PART PLAN OF PROPOSED  
2ND PARYAVARAN ROAD AND  
COMMERCIAL COMPLEX AT  
INDUSTRIAL AREA KISHANGARH  
IVTH PHASE. DIST. AJMER**

SCALE: 1 CM=5.0 M. DRG. NO. IPI/239/2006 DT. 25.01.2006

*P. K. Sharma*  
P. K. SHARMA  
SR. DRAUGHTSMAN

*R. S. Parihar*  
R. S. PARIHAR  
ASST. TOWN PLANNER

PRAVESH JAIN  
DY. TOWN PLANNER