

INDEX

- CLEAR VACANT
- TEMPORARY ENCROACHMENT
- ENCROACHMENT /DISPUTE

**LAKHAWA (UNDEVELOPED)
CODE 894**

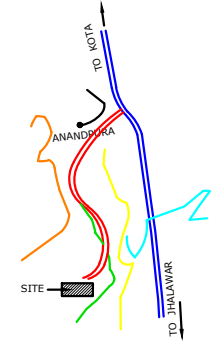
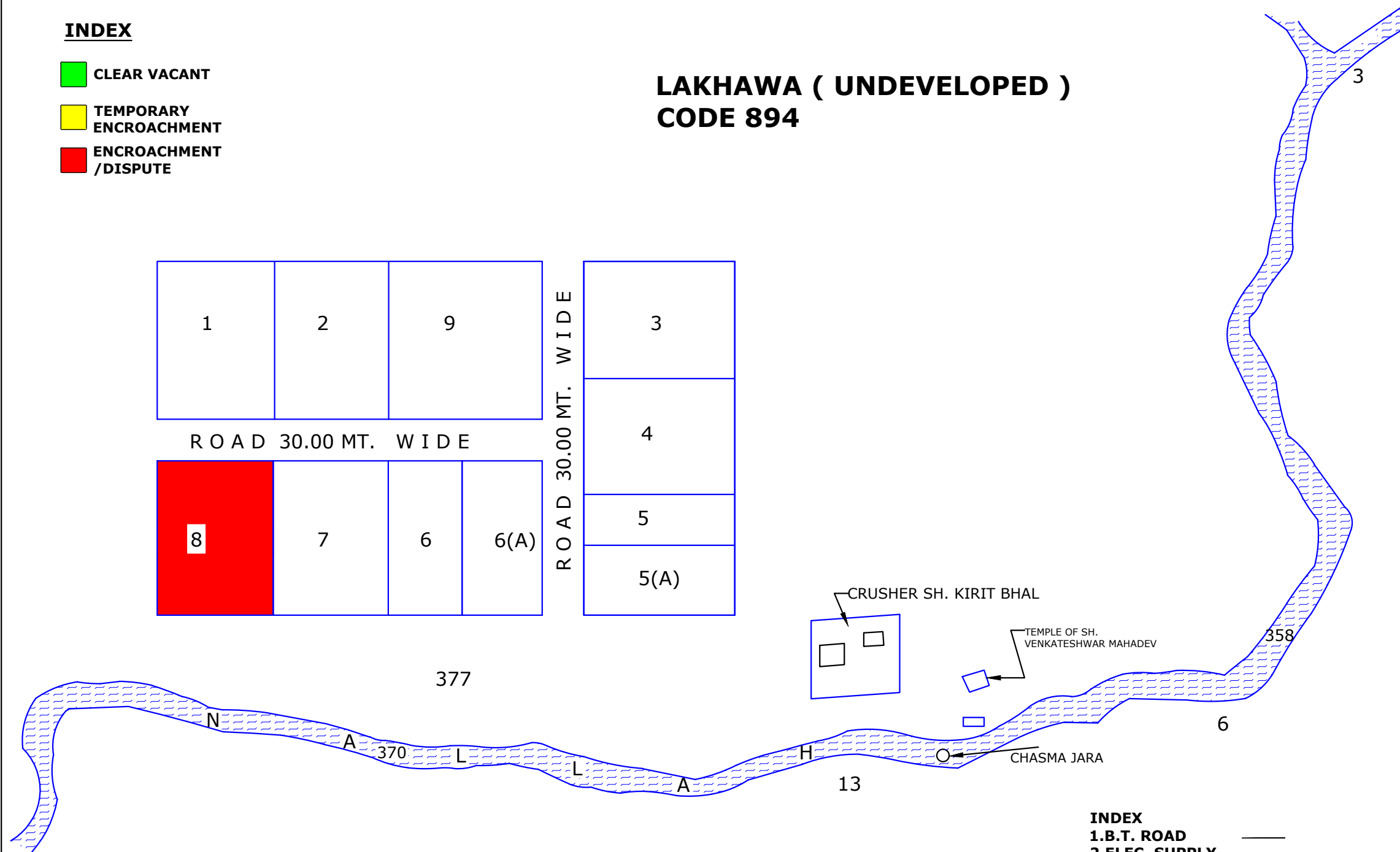
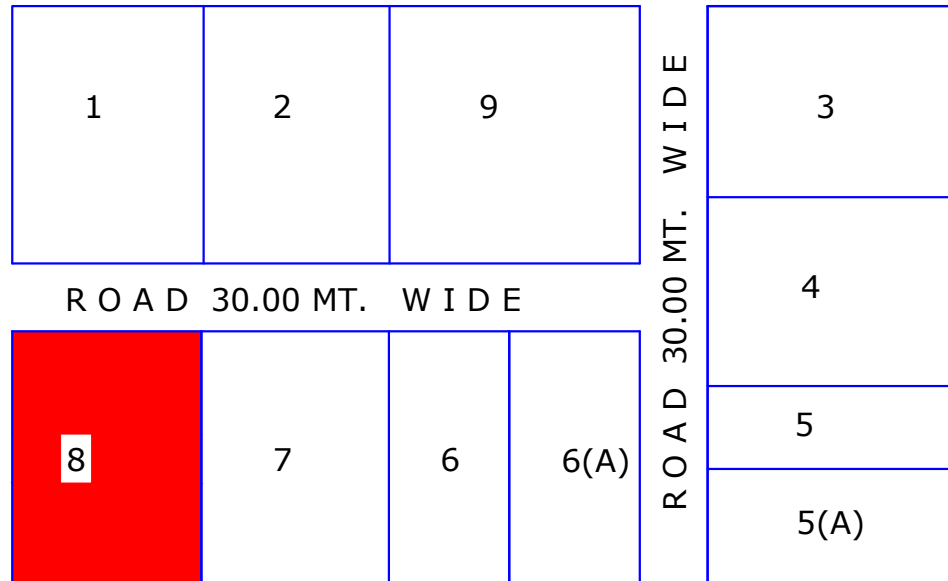

LOCATION PLAN

INDEX

- 1. B.T. ROAD ———
- 2. ELEC. SUPPLY NETWORK/ POLES ———
- 3. WATER SUPPLY NETWORK ———
- 4. WSS wss
- 5. GSS
- 6. BANK B
- 7. POLICE STATION P
- 8. FIRE STATION F
- 9. CETP CETP
- 10. DRAINAGE ———
- 11. GAS LINE — GAS — GAS

FIRE STATION - 5.30 KM (IPIA ROAD NO. 07 fire station)
POLICE POST - 4.50 KM

1. THIS DRAWING HAS BEEN TRACED AS PER RM LETTER NO. 6967 DT. 16.3.89

LAYOUT PLAN OF IND. AREA LAKHAWA (UNDEVELOPED) KH. No 377,359-OR INSTALATION OF CRUSHER AT ANAND PURA ,KOTA

SCALE-1"=80M. DRG. NO. IPI/23/84 DT.26.4.07

Sd/- (K.K.MEHIRCHANDANI) D/MAN

Sd/- (B.S.PARIHAR) Sr.PLANNING ASSTT.

(B.R.P.BHATNAGAR) DY.TOWN PLANNER

